

Top-adaptor sub suitable for most dual wall drill pipe.

Internal screen for collecting debris.

N.R.V. to prevent hammer flooding.

Easy sample tube removal with large bore diameter.

Simplified piston geometry for improved balance and location within the cylinder.

Revised chamber volumes and cycle timing to optimize performance.

Bit catcher to prevent loss of drill bit and seal the hole for sampling.



The RC412 has been designed to give maximum performance in Exploration and Grade Control applications. These hammers have a one piece “integral top-adaptor” which is robust and simple requiring no make-up components, this gives reliability and ease of service. At higher pressures the RC hammers make easy going of even the hardest of rock structures.

RC412 is equipped with a bit catcher to help retrieve shanked bits and collar the hole. The RC4/412 also has a sub adaptor body to suit most dual wall drill pipe.

Suitable for operation at air pressures of 100 - 435 psi (7 - 30 bar).

Drilling diameters of 121 - 136 mm (4 3/4 - 5 3/8”).

### Air Consumption

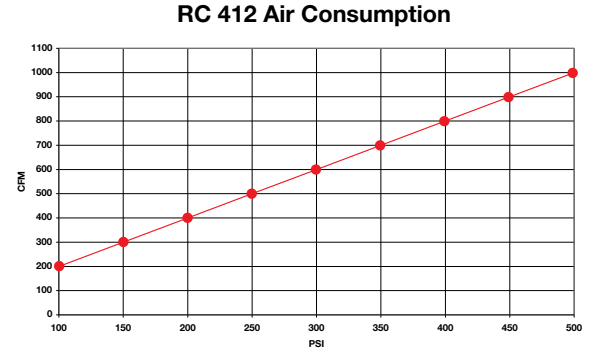

Figures are based on theoretical data

### Available Shanks

Halco RC 412

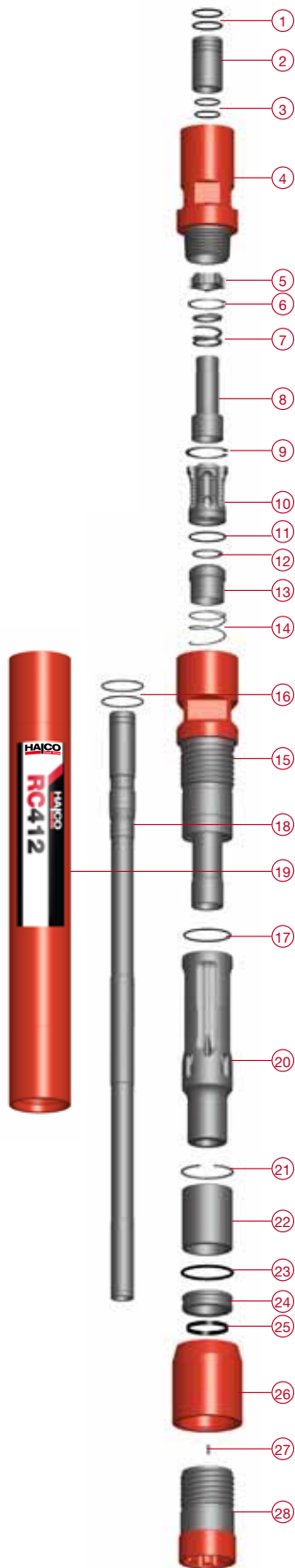

## Hammer Overview

Hammer Type	RC412	
Part Number	600339	600341
Shank	Halco	Halco
	RC412	RC412
Top Thread	Remet 4"	Metzke 4"
Weight	69 Kg	69 Kg
Outside Diameter	116mm (4.567")	116mm (4.567")
Make Up Length	1393mm (54.842")	1393mm (54.842")

## Parts List

Hammer Type	RC412	
Shank	Remet 4"	Metzke 4"
Model Number	600339	600341
Item	Description	Part Numbers
	Sub Adaptor Assy	600611
	600613	600613
1	O'Rings	747120
2	Tube Connector	603848
3	O'Rings	768099
4	Sub Adaptor Body	603966
5	Spider	603821
6	Snap Ring	777019
7	Sample Tube Spring	760139
8	Upper Sample Tube	603824
	Base Hammer	600608
9	Circlip	777044
10	N.R.V. Seat & Filter	603823
11	O'Ring	768135
12	Quad-Ring Seal	768148
13	Non Return Valve	603828
14	N.R.V. Spring	760140
15	Top-Adaptor Assy	603972
16	O'Ring	768127
17	O'Ring	768133
18	Sample Tube	603917
19	Cylinder	603971
20	Piston	603831
21	Snap Ring	783031
22	Guide Bush	603921
23	O'Ring	768183
24	Bit Retaining Ring	603920
25	O'Ring	792037
26	Bit Catcher	See Below
27	Key	603142
28	Chuck	603953
SK	Service Kit	SK52
RK	Repair Kit	RK86

## Drill Bits

Part Number	Diameter		Face Design	Face Type	Buttons		Weight (Kg)
	mm	Inch			Qty/dia		
<b>Halco RC 412</b>							
653178	121	4.3/4	Concave	Domed	16 x 13mm		13.7
653179	127	5	Concave	Domed	8x16mm/9x13mm		14.3
653177	130	5.1/8	Concave	Domed	8x16mm/5x13mm/4x14mm		14.5
653164	133	5.1/4	Concave	Domed	8x16mm/5x13mm/4x14mm		14.7
653194	136	5.3/8	Concave	Domed	8x16mm/5x13mm/4x14mm		15.0

## RC412 Bit Catcher

Outside Diameter	Part Number
118.00 / 118.25	603955
119.50 / 119.75	603956
121.00 / 121.25	603957
122.50 / 122.75	603958
124.00 / 124.25	603959
125.50 / 125.75	603960
127.00 / 127.25	603961
128.50 / 128.75	603962
130.00 / 130.25	603963
131.50 / 131.75	603923
133.00 / 133.25	604013

# RC<sup>™</sup>

## RC 5

Top-adaptor to suit most dual wall pipe and screen.

N.R.V. (Non-Return-Valve) to prevent hammer flooding.

Easy sample tube removal with large bore diameter.

Simplified piston geometry for improved balance and location within the cylinder.

Reversible cylinder for extended life.

Revised chamber volumes and cycle timing to optimize performance.

Bit catcher to prevent loss of drill bit and seal the hole for sampling.



The Halco® RC5 has been designed to give maximum performance in Exploration and Grade Control applications. The new Halco® RC5 provides improved performance and a robust design. With no inner liner, the RC5 has a simple design that reduces complicated maintenance procedures providing less down time and greater savings. The Halco® RC5 is fitted with a reversible cylinder to prolong service life in abrasive conditions.

The Halco RC5 is equipped with a bit catcher to help retrieve shanked bits and collar the hole. The RC5 also has a sub adaptor body to suit most dual wall drill pipe.

Suitable for operation at air pressures of 100 - 435 psi (7 - 30 bar).

Drilling diameters of 137 - 190 mm (5 3/8 - 7 1/2").

### Air Consumption

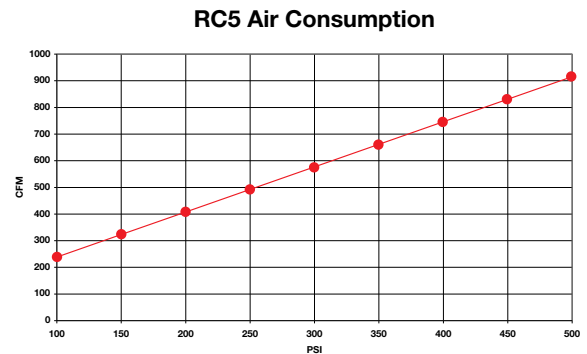

Figures are based on theoretical data

### Available Shanks

Halco RC5 Shank

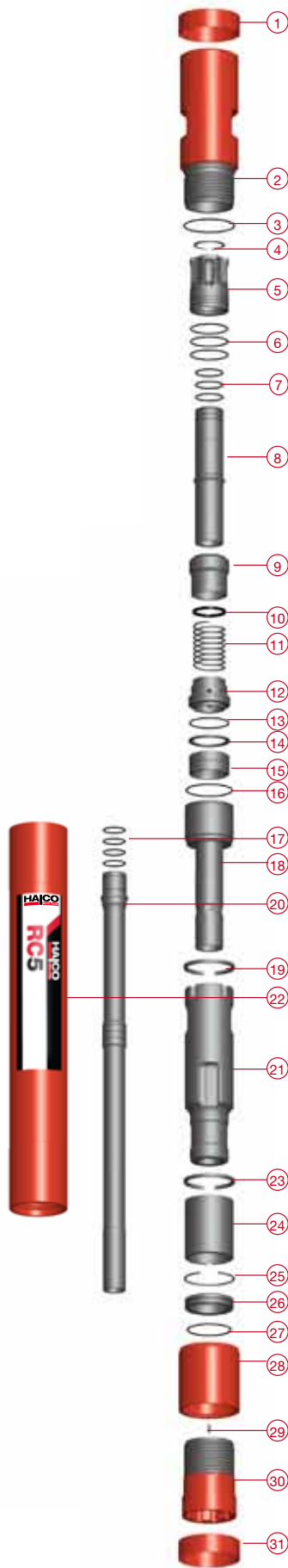

## Hammer Overview

Hammer Type	RC5	RC5
Part Number	600371	600372
Shank	Halco	Halco
	RC5	RC5
Top Thread	Remet 4 1/2"	Hetzke 4.1/2"
Weight	81.6 kg	81.6 kg
Outside Diameter	130mm (5.118")	130mm (5.118")
Make Up Length	1285mm (50.600")	1285mm (50.600")

## Parts List

Hammer Type	RC5		
Shank	Remet 4 1/2"	Metzke 4 1/2"	
Model Number	600371	600372	
Item	Description	Part Number	Part Number
1	Thread Protector	741027	741027
2	Top-Adaptor	604222	604239
3	O'Ring	768165	768165
4	Circlip	756015	756015
5	N.R.V. Seat & Filter	604223	604223
6	O Rings	768041	768041
7	O Rings	747121	-
8	Upper Sample Tube	604262	604261
9	Non Return Valve	604225	604225
10	U Seal	748098	748098
11	N.R.V. Spring	760115	760115
12	Distributor Cap	604291	604291
13	O Ring	768133	768133
14	Shim 4.5mm	604226	604226
	Shim 5.0mm	604227	604227
	Shim 5.5mm	604228	604228
15	Ringfeder Spring	760109	760109
16	O'Ring	768045	768045
17	O'Ring	768127	768127
18	Air Distributor	604236	604236
19	Retaining Ring	604313	604313
20	Sample Tube	604290	604290
21	Piston	604244	604244
22	Cylinder	604218	604218
23	Retaining Ring	604313	604313
24	Piston Guide Bush	604242	604242
25	Snap Ring	783009	783009
26	Bit Retaining Rings	604019	604019
27	O Ring	768091	768091
28	Bit Catcher	See Below	See Below
29	Bit Catcher Key	603142	603142
30	Chuck *	604011	604011
31	End Cap	741053	741053
SK	Service Kit	SK62	SK63
RK	Repair Kit	RK96	RK97

## Drill Bits

Part Number	Diameter		Face Design	Buttons Type	Buttons Qty/dia	Weight (Kg)
	Mm	Inch				
<b>Halco RC</b>						
653199	137	5.3/8	Concave	Domed	8 x 16mm/5 x 13mm/4 x 14mm	18.5
653200	140	5.1/2	Concave	Domed	8 x 16mm/5 x 13mm/4 x 14mm	18.7
653321	143	5.5/8	Concave	Domed	8 x 16mm/6 x 16mm	20.6
653201	146	5.3/4	Concave	Domed	8 x 16mm/5 x 13mm/4 x 14mm	18.9
653202	156	6.1/8	Concave	Domed	12 x 16mm/5 x 13mm	20.0
653203	159	6.1/4	Concave	Domed	12 x 16mm/5 x 13mm	21.0
653214	190	7.1/2	Concave	Domed	16 x 16mm/10 x 13mm	24.0

Outside Diameter	Part Number
133.00 / 133.25	604030
136.00 / 136.25	604016
139.00/139.25	604356
142.00 / 142.25	604031
152.00 / 152.25	604032
155.50 / 155.25	604033
185.00 / 185.25	604102