

12"

SUPER DOMINATOR 1200

Heavy duty top-adaptor with box connection reduces internal parts. No make up required. External N.R.V. for easy maintenance.

Simplified piston geometry for improved balance and location within the cylinder.

Revised chamber volumes and cycle timing to optimize performance.

Replaceable bit bearings.

QL120 shank reduces contact stresses and wear rates.

Replaceable bit bearings.

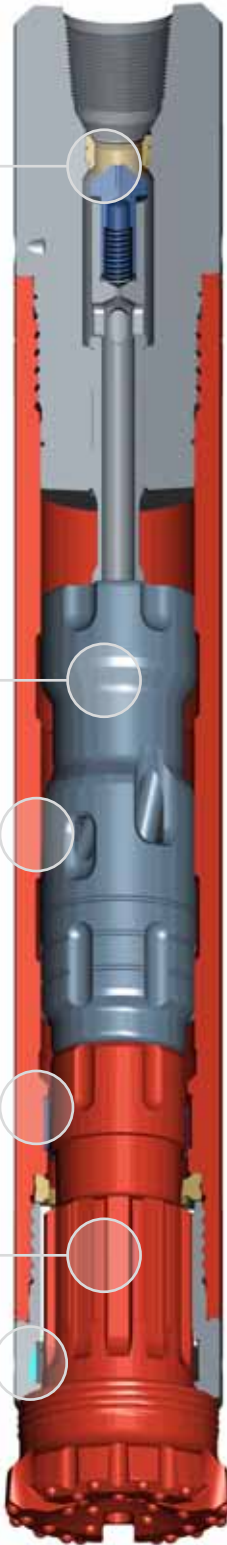

The Super Dominator 1200 accepts QL120 shank bits and drills most efficiently at air pressures between 100 psi (7 bar) and 435 psi (30 bar). Due to its higher air consumption, it provides increased uphole velocity, particularly when using oversized diameter drill bits.

The Super Dominator 1200 has a one piece top-adaptor with N.R.V. (Non-Return-Valve) fitted for easy inspection and service, with integral finger to reduce maintenance and eliminate shimming which increases service intervals. The Super Dominator 1200 has a robust top-adaptor for extra strength.

Suitable for operation at air pressures of 100 - 435 psi (7 - 30 bar).

Drilling diameters of 311 - 445mm (12 - 17 1/2").

Air Consumption

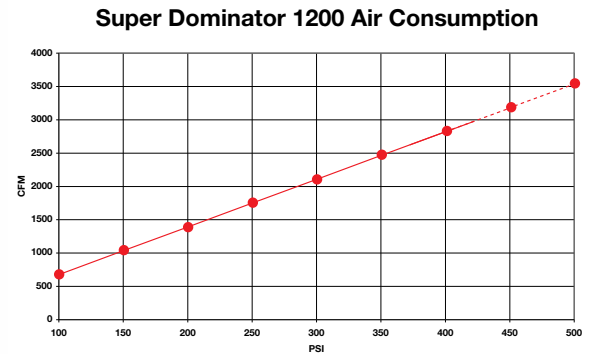

Figures are based on theoretical data

Available Shanks

IR QL 120

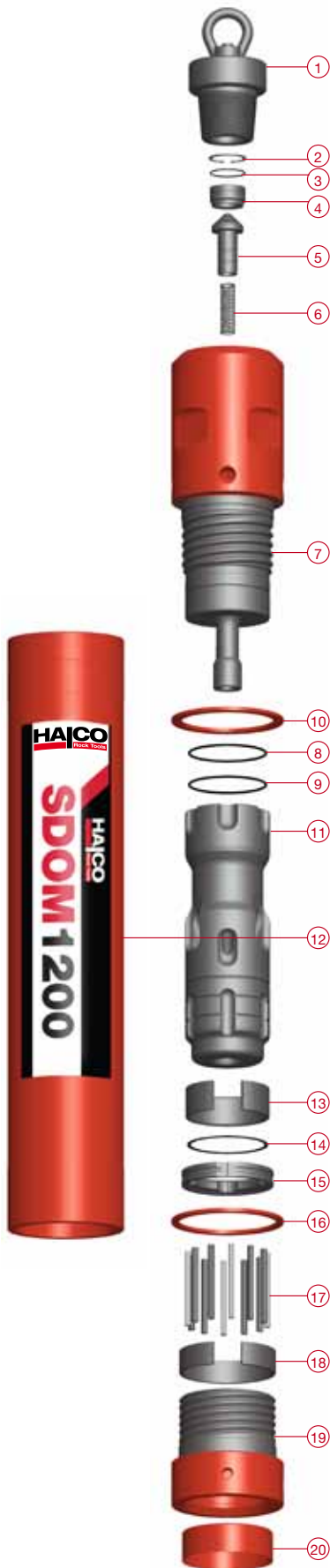

Hammer Overview

Hammer Type	Super Dominator 1200
Part Number	600373
Shank	Ingersoll Rand QL 120
Top Thread	6 .5/8" Api Reg Box
Flat Hammer Size	260mm (10.236")
Weight	807 Kg
Outside Diameter	284mm (11.181")
Make Up Length	1978mm (77.874")
Recommended Minimum Thrust	1600 Kg (3520 Lbs)
Recommended Maximum Thrust	3500 Kg (7700 Lbs)

Parts List

Hammer Type	Super Dominator 1200
-------------	----------------------

Shank	Q1120
-------	-------

Model Number	600373
--------------	--------

Item	Description	Part Number
------	-------------	-------------

1	Lifting Cap	604284
---	-------------	--------

2	Circlip	777001
---	---------	--------

3	O'Ring	768133
---	--------	--------

4	N.R.V. Seat	602286
---	-------------	--------

5	Non Return Valve	602288
---	------------------	--------

6	N.R.V. Spring	760055
---	---------------	--------

7	Top-Adaptor	604282
---	-------------	--------

8	Top-Adaptor Spacer	603575
---	--------------------	--------

8	O'Ring	768137
---	--------	--------

10	O'Ring	768137
----	--------	--------

11	Piston	603572
----	--------	--------

12	Cylinder	603565
----	----------	--------

13	Inner Bearing Ring	603566
----	--------------------	--------

14	Containment Band	603581
----	------------------	--------

15	Bit Retaining Ring	603567
----	--------------------	--------

16	Chuck Spacer	603568
----	--------------	--------

17	Drive Pins	600595
----	------------	--------

18	Chuck Bearing	603563
----	---------------	--------

19	Chuck	603562
----	-------	--------

20	End Cap	741050
----	---------	--------

SK	Service Kit	SK47
----	-------------	------

RK	Repair Kit	RK76
----	------------	------

	Foot Valve	603561
--	------------	--------

	F/V - Body	603582
--	------------	--------

	F/V - Pusher	603583
--	--------------	--------

Drill Bits

Part Number	Diameter		Face Design	Type	Buttons Qty	Weight (Kg)
	mm	Inch				
QL 120 Shank						
653034	311	12.1/4	Concave	Domed	31 x 20mm	168
653089	314	12.3/8	Concave	Domed	32 x 20mm	168
653035	445	17.1/2	Concave	Domed	82x20mm / 30x16mm Wear	271

12"

MACH 120

One piece top-adaptor reduces internal parts. No make up required. External N.R.V. for easy maintenance.

Simplified piston geometry for improved balance and location within the cylinder.

Revised chamber volumes and cycle timing to optimize performance.



The Mach 120 accepts A100-15 (SD12) shank bits and its optimum performance is reached at air pressures of 200psi (14 bar) and above. The Mach 120 has a one piece top-adaptor with N.R.V. (Non-Return-Valve) fitted for easy inspection and service, with integral finger to reduce maintenance and eliminate shimming which increases service intervals. Mach 120 has no liner which increases the 140 kg piston's blow energy and reduces parts required. This hammer is suitable for use with overburden systems.

Suitable for operation at air pressures of 100 - 435 psi (7 - 30 bar).

Drilling diameters of 300 - 445mm (11 7/8 - 17 1/2").

Air Consumption

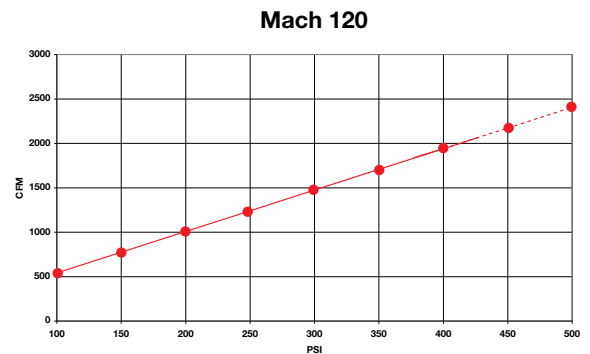

Figures are based on theoretical data

Available Shanks

Sandvik Mission A100-15/SD12

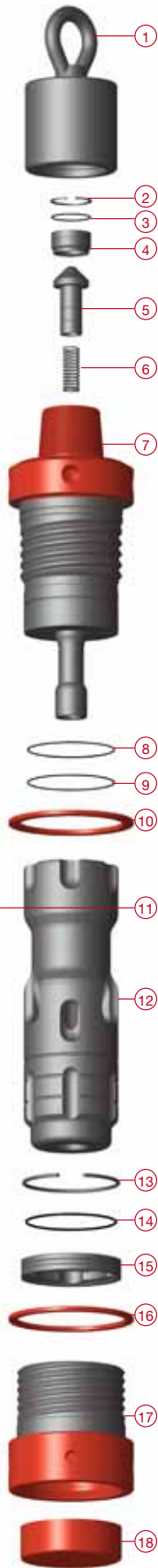

Hammer Overview

Hammer Type	Mach 120
Part Number	600108
Shank	Sandvik Mission
	A100-15 / SD12
Top Thread	6 .5/8" Api Reg Pin
Flat Hammer Size	N/A
Weight	614 Kg
Outside Diameter	273mm (10.748")
Make Up Length	1667mm (65.629")
Recommended Minimum Thrust	1600 Kg (3520 Lbs)
Recommended Maximum Thrust	3500 Kg (7700 Lbs)

Parts List

Hammer Type	Mach120	
Shank	A100-15/SD12	
Model Number	600108	
Item	Description	Part Number
1	Lifting Cap	602354
2	Circlip	777001
3	O'Ring	768133
4	N.R.V. Seat	602286
5	Non Return Valve	602288
6	N.R.V. Spring	760055
7	Top-Adaptor	602639
8	O'Ring	768137
9	O'Ring	768137
10	Top-Adaptor Spacer	602366
11	Cylinder	602013
12	Piston	602047
13	Snap Ring	783021
14	Containment Band	768105
15	Bit Retaining Ring	602102
16	Chuck Spacer	602366
17	Chuck	602052
18	End Cap	741035
SK	Service Kit	SK12
RK	Repair Kit	RK19
	Foot Valve	601811
	F/V Tool - Body	601812
	F/V Tool - Pusher	601813

Drill Bits

Part Number	Diameter		Face		Buttons		Over Size	Weight (Kg)
	mm	Inch	Design	Type	Qty			
Halco/ Sandvik Mission A100-15/SD12 Shank								
650874	300	11.7/8	Convex	Domed	29 x 20mm			138
650383	311	12.1/4	Concave	Domed	31 x 20mm			133.5
650988	381	15	Concave	Domed	65 x 20mm D / 18 x 16mm W			208
653138	406	16	Concave	Domed	74 x 20mm D / 18 x 16mm W			210
650376	445	17.1/2	Concave	Domed	79 x 20mm		Y	245

12"

MACH 122

One piece top-adaptor reduces internal parts. No make up required. External N.R.V. for easy maintenance.

Simplified piston geometry for improved balance and location within the cylinder.

Revised chamber volumes and cycle timing to optimize performance.



The Mach 122 accepts A100-15 (SD12) shank bits and works over a wide pressure range with an optimum performance reached at air pressures of 200 psi (14 bar) and above as its higher air consumption provides increased uphole velocity, particularly when using oversized diameter drill bits.

Mach 122 has a one piece top-adaptor with N.R.V. (Non-Return-Valve) fitted for easy inspection and service, with integral finger to reduce maintenance and eliminate shimming which increases service intervals. Mach 122 has no liner which increases the 140 kg piston blow energy and reduces parts required. This hammer is suitable for use with overburden systems.

Suitable for operation at air pressures of 100 - 435 psi (7 - 30 bar).

Drilling diameters of 300 - 445mm (11 7/8 - 17 1/2").

Air Consumption

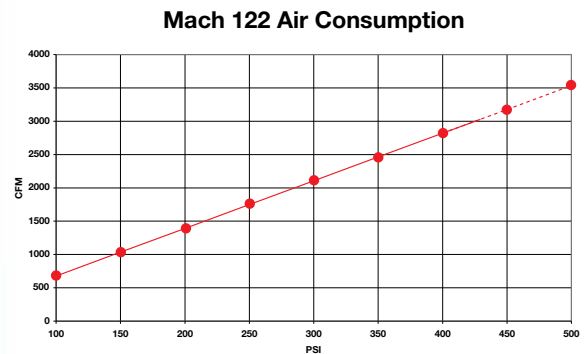

Figures are based on theoretical data

Available Shanks

Sandvik Mission A100-15/SD12

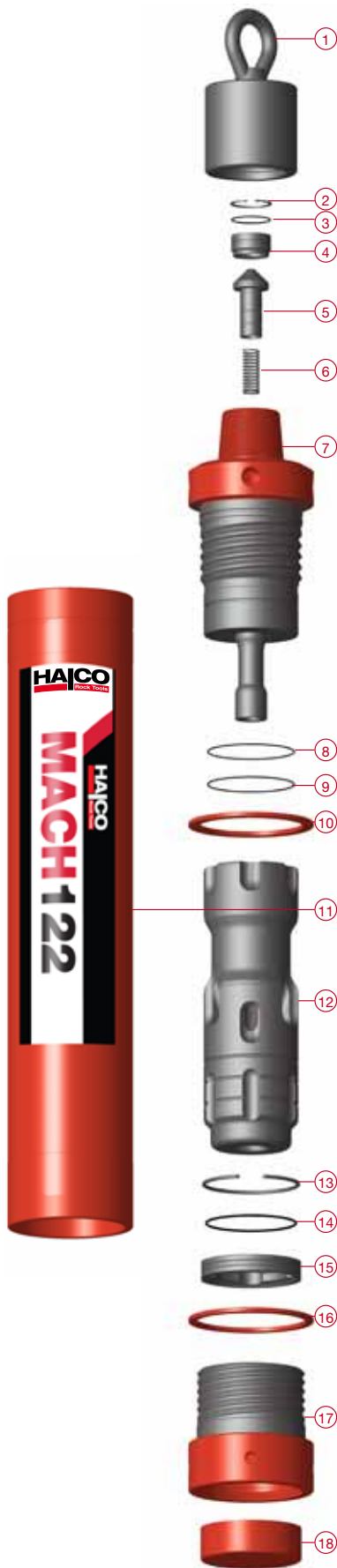

Hammer Overview

Hammer Type	Mach 122
Part Number	600110
Shank	Sandvik Mission
	A100-15/SD12
Top Thread	6 .5/8" Api Reg Pin
Flat Hammer Size	N/A
Weight	614 Kg
Outside Diameter	273mm (10.748")
Make Up Length	1667mm (65.629")
Recommended Minimum Thrust	1600 Kg (3520 Lbs)
Recommended Maximum Thrust	3500 Kg (7700 Lbs)

Parts List

Hammer Type	Mach122	
Shank	A100-15 / SD12	
Model Number	600110	
Item	Description	Part Number
1	Lifting Cap	602354
2	Circlip	777001
3	O'Ring	768133
4	N.R.V. Seat	602286
5	Non Return Valve	602288
6	N.R.V. Spring	760055
7	Top-Adaptor	602639
8	O'Ring	768137
9	O'Ring	768137
10	Top-Adaptor Spacer	602366
11	Cylinder	602425
12	Piston	602047
13	Snap Ring	783021
14	Containment Band	768105
15	Bit Retaining Ring	602102
16	Chuck Spacer	602366
17	Chuck	602052
18	End Cap	741035
SK	Service Kit	SK12
RK	Repair Kit	RK19
	Foot Valve	601811
	F/V Tool - Body	601812
	F/V Tool - Pusher	601813

Drill Bits

Part Number	Diameter		Face		Buttons Qty	Over Size	Weight (Kg)
	mm	Inch	Design	Type			
Halco/ Sandvik Mission A100-15/SD12 Shank							
650874	300	11.7/8	Convex	Domed	29 x 20mm		138
650383	311	12.1/4	Concave	Domed	31 x 20mm		133.5
650988	381	15	Concave	Domed	65 x 20mm D / 18 x 16mm W		208
653138	406	16	Concave	Domed	74 x 20mm D / 18 x 16mm W		210
650376	445	17.1/2	Concave	Domed	79 x 20mm	Y	245

12"

MACH 132

One piece top-adaptor reduces internal parts. No make up required. External N.R.V. for easy maintenance.

Simplified piston geometry for improved balance and location within the cylinder.

Revised chamber volumes and cycle timing to optimize performance.



The Mach 132 hammer accepts IR DHD112 shank bits. This hammer, although capable of high pressure drilling is particularly suitable at pressures between 100-200 psi (7 - 14 bar). The Mach 132 has a pin drive system to prevent metal to metal contact thereby minimizing spline wear and damage which can result in drill bit shank failure.

Mach 132 has a one piece top-adaptor with N.R.V. (Non-Return-Valve) fitted for easy inspection and service, with integral finger to reduce maintenance and eliminate shimming which increases service intervals. Servicing requires only a few simple tools. Mach 132 has no liner which increases the 140 kg piston blow energy and reduces parts required. This hammer is suitable for use with overburden systems.

Suitable for operation at air pressures of 100 - 435 psi (7 - 30 bar).

Drilling diameters of 381 - 489 mm (15 - 19 1/4").

Air Consumption

Mach 132 Air Consumption

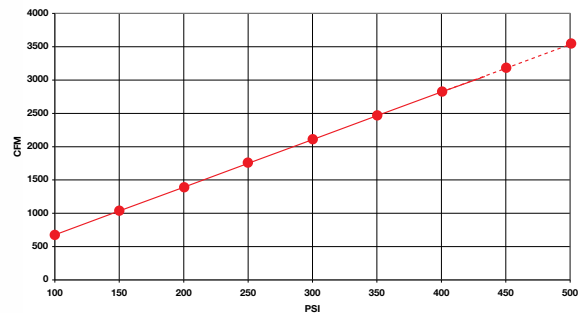

Figures are based on theoretical data

Available Shanks

IR DHD 112

12"

MACH 132

One piece top-adaptor reduces internal parts. No make up required. External N.R.V. for easy maintenance.

Simplified piston geometry for improved balance and location within the cylinder.

Revised chamber volumes and cycle timing to optimize performance.



The Mach 132 hammer accepts IR DHD112 shank bits. This hammer, although capable of high pressure drilling is particularly suitable at pressures between 100-200 psi (7 - 14 bar). The Mach 132 has a pin drive system to prevent metal to metal contact thereby minimizing spline wear and damage which can result in drill bit shank failure.

Mach 132 has a one piece top-adaptor with N.R.V. (Non-Return-Valve) fitted for easy inspection and service, with integral finger to reduce maintenance and eliminate shimming which increases service intervals. Servicing requires only a few simple tools. Mach 132 has no liner which increases the 140 kg piston blow energy and reduces parts required. This hammer is suitable for use with overburden systems.

Suitable for operation at air pressures of 100 - 435 psi (7 - 30 bar).

Drilling diameters of 381 - 489 mm (15 - 19 1/4").

Air Consumption

Mach 132 Air Consumption

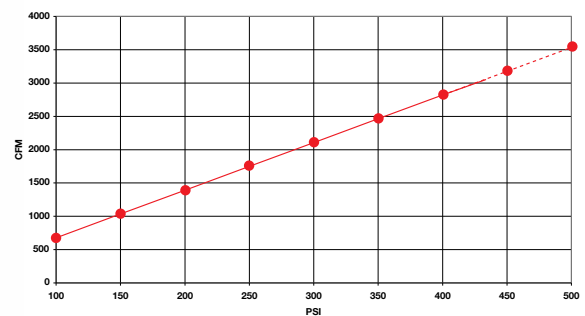

Figures are based on theoretical data

Available Shanks

IR DHD 112

12"

MACH 142

One piece top-adaptor reduces internal parts. No make up required. External N.R.V. for easy maintenance.

Revised chamber volumes and cycle timing to optimize performance.

Simplified piston geometry for improved balance and location within the cylinder.

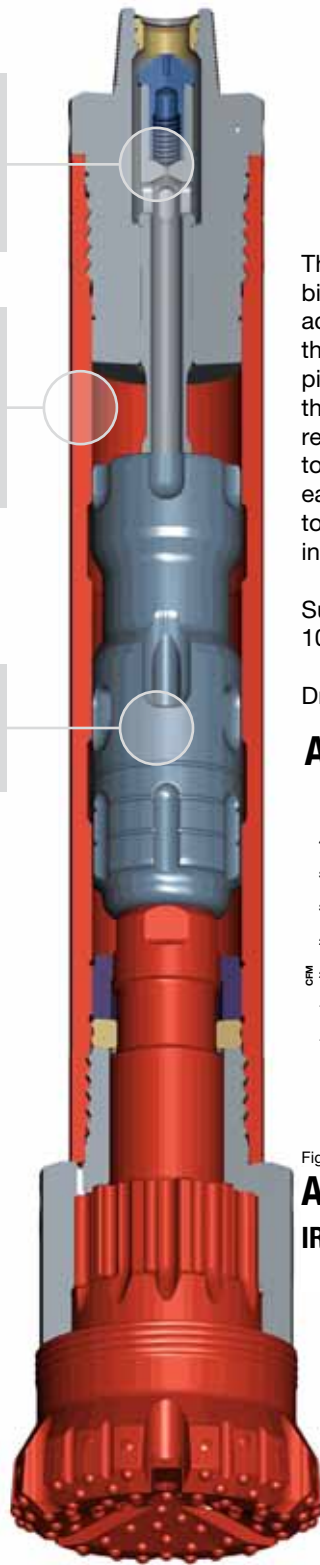

The Mach 142 hammer accepts IR DHD112S shank bits and is equipped with an oversized chuck to accommodate this shank. This oversized chuck protects the cylinder and prolongs its life. This hammer has a pin drive arrangement to prevent metal to metal contact thereby minimising spline wear and damage which can result in drill bit shank failure. Mach 142 has a one piece top-adaptor with N.R.V. (Non-Return-Valve) fitted for easy inspection and service, with integral finger to reduce maintenance and eliminate shimming which increases service intervals.

Suitable for operation at air pressures of 100 - 350 psi (7 - 24 bar).

Drilling diameters of 438 - 660mm (17 1/4 - 26").

Air Consumption

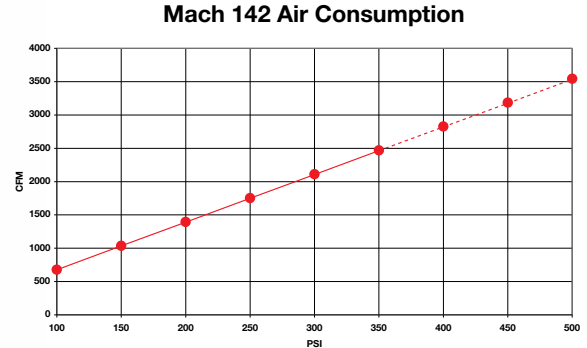

Figures are based on theoretical data

Available Shanks

IR DHD 112S



Hammer Overview

Hammer Type	Mach 142
Part Number	600143
Shank	Ingersoll Rand
	DHD 112S
Top Thread	6 .5/8" Api Reg Pin
Flat Hammer Size	N/A
Weight	688 Kg
Outside Diameter	273mm (10.748")
Make Up Length	1819mm (71.614")
Recommended Minimum Thrust	1600 Kg (3520 Lbs)
Recommended Maximum Thrust	3500 Kg (7700 Lbs)

Parts List

Hammer Type	Mach142	
Shank	DHD112S	
Model Number	600143	
Item	Description	Part Number
1	Lifting Cap	602354
2	Circlip	777001
3	O'Ring	768133
4	N.R.V. Seat	602286
5	Non Return Valve	602288
6	N.R.V. Spring	760055
7	Top-Adaptor	602639
8	O'Ring	768137
9	O'Ring	768137
10	Top-Adaptor Spacer	602366
11	Cylinder	602563
12	Piston	602532
13	Snap Ring	783021
14	Bearing Bush	602531
15	O'Ring	768184
16	Containment Band	603819
17	Bit Retaining Ring	602530
18	Chuck Spacer	602985
19	Drive Pins	600565
20	Chuck	602529
21	End Cap	741037
SK	Service Kit	SK15
RK	Repair Kit	RK24
	Foot Valve	602522
	F/V Tool - Body	602523
	F/V Tool - Pusher	601813

Drill Bits

Part Number	Diameter		Face		Buttons Qty	Over Size	Weight (Kg)
	mm	Inch	Design	Type			
Mach 142/DHD 112S Shank							
650018	438	17.1/4	Concave	Domed	82 x 20mm / 18 x 16mm Wear	Y	354
650964	508	20	Concave	Domed	91 x 20mm / 36 x 16mm Wear	Y	470
650907	610	24	Concave	Domed	123 x 20mm / 66 x 16mm Wear	Y	512
653126	660	26	Convex	Domed	171 x 20mm / 39 x 16mm Wear	Y	600