

4"

MACH 44

Top-adaptor with integral N.R.V. (Non-Return-Valve) replaceable air distributor.

Simplified piston geometry for improved balance and location within the cylinder.

Revised chamber volumes and cycle timing to optimize performance.

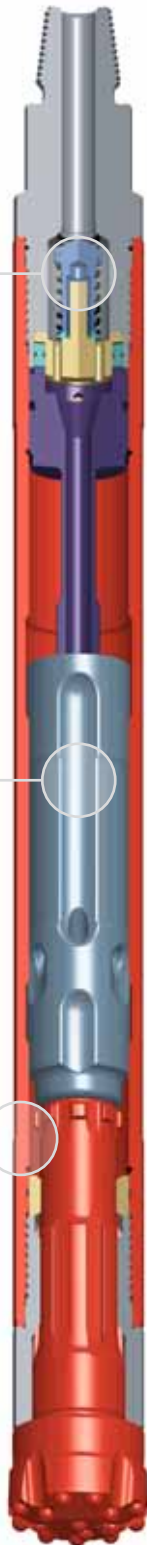

The Mach 44 is a general purpose hammer suitable for all rock conditions at a wide range of air pressures. The Mach 44 has a proven track record of performance and reliability. The high frequency of the Mach 44 makes it ideal when using overburden systems for broken or unstable ground conditions.

Suitable for operation at air pressures of 100 - 350 psi (7 - 24 bar).

Drilling diameters of 105mm - 150mm (4 1/4 - 5 7/8").

Air Consumption

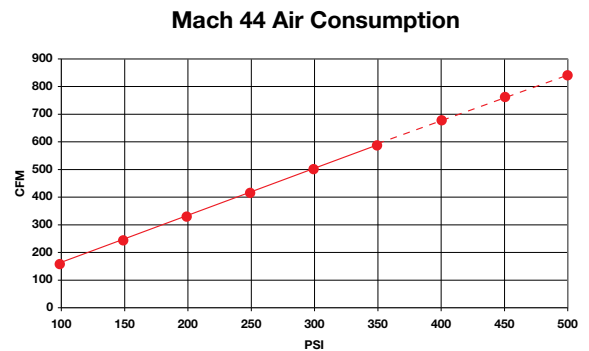

Figures are based on theoretical data

Available Shanks

Halco Mach 44



Hammer Overview

Hammer Type	Mach 44
Part Number	600070
Shank	Halco Mach 44
Top Thread	2.3/8 API REG PIN
Flat Hammer Size	65mm (2.560")
Weight	35.3 Kg
Outside Diameter	95mm (3.3/4")
Make Up Length	1000mm (39.3/8")
Recommended Minimum Thrust	250 Kg (550 lbs)
Recommended Maximum Thrust	500 Kg (1100 lbs)

Parts List

Hammer Type	Mach 44	
Shank	Halco	
Model Number	600070	
Item	Description	Part Number
1	Thread Protector	200111
2	Top-Adaptor	601632
3	O Ring	768040
4	N.R.V.	602330
5	N.R.V. Spring	760084
6	N.R.V. Seat	601778
7	N.R.V. Finger	601717
8	Shim - 0.5mm	601640
	Shim - 1.0mm	601720
	Shim - 1.5mm	601721
9	Compression Ring	601635
10	O Ring	768050
11	Air Distributor	601868
12	Cylinder	601865
13	Snap Ring	783014
14	Piston	602456
15	Snap Ring	783014
16	Bit Retaining Ring	601945
17	Containment Band	792037
18	Chuck Spacer	601431
19	Chuck	601439
20	End Cap	741019
SK	Service Kit	SK02
RK	Repair Kit	RK02
	Foot Valve	601641
	F/V tool - body	601643
	F/V tool - pushert	601644

Drill Bits

Part Number	Diameter		Face Design	Buttons Type	Buttons Qty/dia	Over Size	Weight (Kg)
	mm	Inch					
Halco Mach 44							
650788	108	4.1/4	Convex	Domed	13 x 13mm		9.5
650987	108	4.1/4	Convex	Semi-Ballistic	15 x 13mm		9.1
653248	108	4.1/4	Concave	Domed/ Ballistic	8 x 11mm D/ 8 x 11mm B		9.1
650931	110	4.5/16	Convex	Domed	15 x 13mm		9.6
653106	110	4.5/16	Convex	Semi-Ballistic	18 x 11mm		9
650932	115	4.1/2	Convex	Domed	8 x 14mm / 8 x 13mm		9.7
650969	115	4.1/2	Convex	Semi-Ballistic	16 x 13mm		9.6
653136	115	4.1/2	Convex	Parabolic	17 x 14mm		9.5
653249	115	4.1/2	Concave	Domed/ Ballistic	8 x 13mm D/ 8 x 13mm B		9.6
650933	120	4.3/4	Convex	Domed	8 x 14mm / 8 x 13mm		10
650466	127	5	Convex	Domed	16 x 13mm	Y	11
650073	130	5.1/8	Convex	Ballistic	16 x 13mm	Y	10.9
650444	140	5.1/2	Convex	Domed	17 x 13mm	Y	12.5
650445	150	5.7/8	Convex	Domed	17 x 13mm	Y	13.5

4"

DOMINATOR 450

One piece top-adaptor reduces internal parts. No make up required. External N.R.V. for easy maintenance.

Revised cylinder porting to maximise air flow efficiency.

Simplified piston geometry for improved balance and location within the cylinder.

Revised chamber volumes and cycle timing to optimize performance.

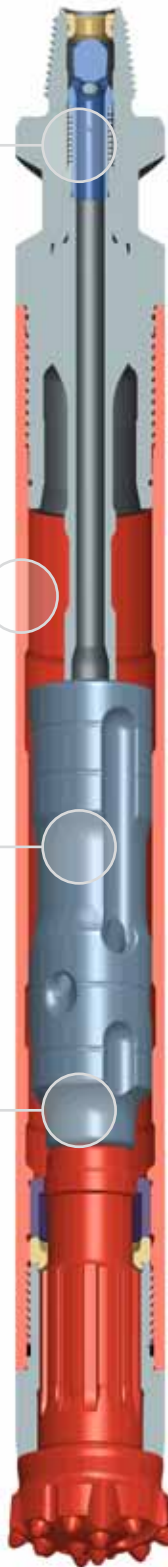

The Super Dominator 450 has been specifically designed for high production drilling in blast-hole applications.

The hammer is robust and has few parts, making it user friendly and reliable. The Super Dominator 450 is fitted with a non-return-valve in top-adaptor for quick and easy inspection and maintenance operations. A fixed air distributor in the top-adaptor body means the Super Dominator 450 requires no shimming which simplifies servicing. The Super Dominator 450 has no liner which increases the piston power output.

The Super Dominator 450 utilizes Halco's all new 12 spline shank which has simplistic robust geometry combined with increased drive contact area. The Super Dominator 450 can be also used with the IR340A/Atlas Copco Cop 44.

Suitable for operation at air pressures of 100 - 350 psi (7 - 24 bar).

Drilling diameters of 110mm - 127mm (4 5/16 - 5").

Air Consumption

SDOM 450 Air Consumption

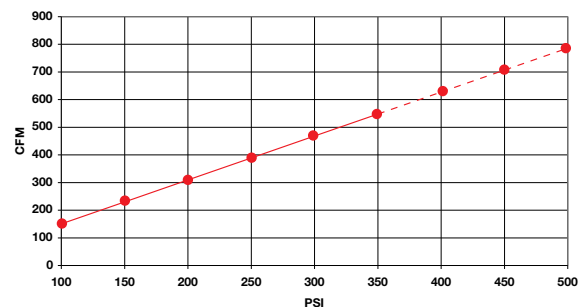

Figures are based on theoretical data

Available Shanks

Halco Super Dominator 450 (NT4)IR

340A/Atlas Copco Cop 44

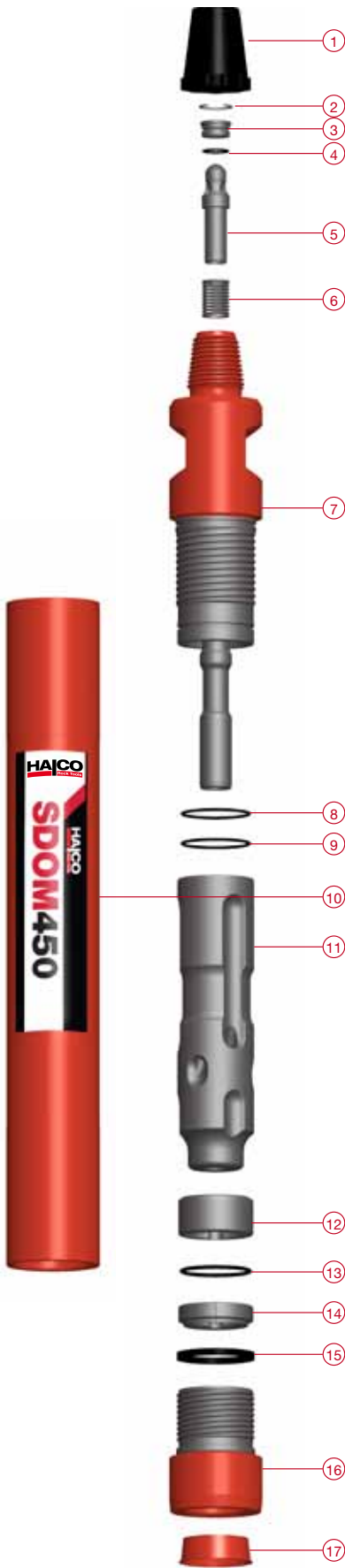

Hammer Overview

Hammer Type	Super Dominator 450	Super Dominator 450
Part Number	600382	600384
Shank	Halco Super Dominator 450	IR DHD 340
Top Thread	2.3/8" API REG PIN	2.3/8" API REG PIN
Hammer Flat Size	65mm (2.560")	65mm (2.560")
Weight	38.5 Kg	38.5 Kg
Outside Diameter	100.5mm (3.956")	100.5mm (3.956")
Make Up Length	914mm (35.984")	914mm (35.984")
Recommended Minimum Thrust	250 Kg (550 lbs)	250 Kg (550 lbs)
Recommended Maximum Thrust	500 Kg (1100 lbs)	500 Kg (1100 lbs)

Parts List

Super Dominator 450		Super Dominator 450	Super Dominator 450
Model		600382	600384
Item	Description	Part Number	
1	Thread Protector	200111	200111
2	Snap Ring	783049	783049
3	N.R.V. Seat	603919	603919
4	O'Ring	768187	768187
5	Non Return Valve	603918	603918
6	N.R.V. Spring	760142	760142
7	Top-Adaptor	603946	603946
8	O'Ring	768190	768190
9	O'Ring	768190	768190
10	Cylinder	604387	604387
11	Piston	604392	604392
12	Bit Guide Bush	604314	-
13	O'Ring	768189	-
14	Bit Retaining Ring	603948	604414
15	Chuck Lock Ring	602733	602733
16	Chuck	603939	604415
17	End Cap	741019	741046
	Foot Valve	603951	601773
	F/V tool - body	604020	601643
	F/V tool - pusher	601644	601644
	Service Kit	SK59	SK59
	Repair Kit	RK93	RK102

Drill Bits

Part Number	Diameter		Face Design	Face Type	Buttons Qty/Dia	Over Size	Weight (Kg)
	mm	Inch					
Halco Super Dominator 450							
653217	110	4.5/16	Convex	Ballistic	14 x 14mm		7.96
653223	110	4.5/16	Convex	Domed	14 x 14mm		7.96
653209	115	4.1/2	Convex	Ballistic	15 x 14mm		8.13
653197	127	5	Convex	Ballistic	18 x 14mm	Y	9.05
653268	127	5	Concave	Domed	8 x 13mm + 8 x 14mm	Y	8.75
IR DHD 340A Shank/Atlas Copco Cop 44							
650950	108	4.1/4	Convex	Domed	15 x 13mm		8
650968	108	4.1/4	Convex	Semi-Ballistic	15 x 13mm		10
650949	110	4.5/16	Convex	Domed	15 x 13mm		8.1
650961	110	4.5/16	Convex	Semi-Ballistic	15 x 13mm		8.1
653091	110	4.5/16	Convex	Parabolic	14 x 14mm		8.5
650526	115	4.1/2	Convex	Domed	16 x 13mm		8.2
650625	115	4.1/2	Concave	Domed/Semi-Ballistic	8 x 14mm D/6 x 13mm S/B		8.2
650955	115	4.1/2	Flat	Domed	8 x 14mm/10 x 13mm		8.3
650967	115	4.1/2	Convex	Semi-Ballistic	16 x 13mm		8.5
650680	120	4.3/4	Concave	Domed/Semi-Ballistic	8 x 13mm/8 x 13mm		10
650612	121	4.3/4	Convex	Semi-Ballistic	14 x 13mm		9.5
650611	127	5	Concave	Domed	16 x 13mm	Y	9.5
650966	127	5	Concave	Semi-Ballistic	16 x 13mm	Y	9.6
650013	127	5	Convex	Domed	16 x 13mm	Y	10.6
650614	130	5.1/8	Concave	Domed/Semi-Ballistic	8 x 14mm D/8 x 13mm S/B	Y	10.1
650675	130	5.1/8	Convex	Semi-Ballistic	16 x 13mm	Y	9.2
653094	140	5.1/2	Concave	Domed	9 x 16mm/9 x 14mm	Y	11.8

4"

SUPER DOMINATOR 400

Top-adaptor with integral N.R.V. (Non-Return-Valve) replaceable air distributor.

Revised chamber volumes and cycle timing to optimize performance.

Simplified piston geometry for improved balance and location within the cylinder.

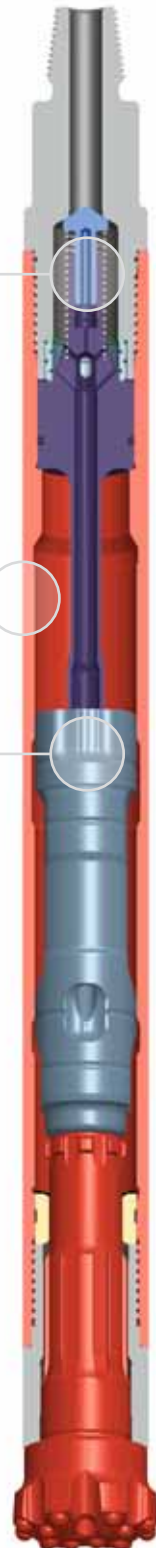

The Super Dominator 400 is a heavy duty hammer with thicker 98mm (3.8") diameter outer components to provide an extended service life in abrasive conditions and is also suitable for waterwell drilling.

The Super Dominator 400 is designed for maximum performance at higher pressures.

Suitable for operation at air pressures of 100 - 350 psi (7 - 24 bar).

Drilling diameters of 108mm - 150mm (4 1/4 - 5 7/8").

Air Consumption

Super Dominator 400 Air Consumption

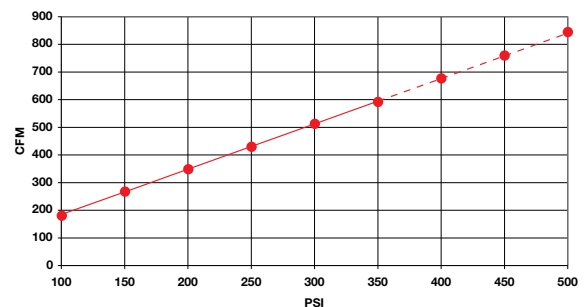

Figures are based on theoretical data

Available Shanks

Halco Mach 44

A34-15/SD4

IR DHD 340A



Hammer Overview

Hammer Type	Super Dominator 400		
Part Number	600224	600226	600258
Shank	Halco	Sandvik Mission	Ingersoll Rand
	Mach 44	A34 -15/SD4	DHD 340A
Top Thread	2.3/8 API REG PIN	2.3/8 API REG PIN	2.3/8 API REG PIN
Hammer Flat Size	65mm (2.560")	65mm (2.560")	65mm (2.560")
Weight	38 Kg	38 Kg	38 Kg
Outside Diameter	98mm (3.7/8")	98mm (3.7/8")	98mm (3.7/8")
Make Up Length	1042mm (41")	1042mm (41")	1042mm (41")
Recommended Minimum Thrust	250 Kg (550 lbs)	250 Kg (550 lbs)	250 Kg (550 lbs)
Recommended Maximum Thrust	500 Kg (1100 lbs)	500 Kg (1100 lbs)	500 Kg (1100 lbs)

Parts List

Hammer Type	Super Dominator 400		
Shank	Halco-SP	A34-15 / SD4	DHD340A
Model Number	600224	600226	600258
Item	Description	Part Number	
1	Thread Protector	200111	200111
2	Top-Adaptor	603215	603215
3	O Ring	768040	768040
4	N.R.V.	602633	602633
5	N.R.V. Spring	760108	760108
	Shim - 4.9mm	602634	602634
6	Shim - 5.3mm	602635	602635
	Shim - 5.7mm	602636	602636
7	Compression Spring	760107	760107
8	Air Distributor	603266	603266
9	O Ring	768050	768050
10	Cylinder	603390	603390
11	Piston	603396	603441
12	Snap Ring	783029	783029
13	Containment Band	792037	-
14	Bit Retaining Ring	603793	603439
15	Chuck Lock Ring	602733	602733
16	Chuck	603273	603274
17	End Cap	741019	741046
SK	Service Kit	SK30	SK30
RK	Repair Kit	RK52	RK42
	Foot Valve	601641	601842
	F/V tool - body	601643	601848
	F/V tool - pushert	601644	601644

Drill Bits

Part Number	Diameter mm	Inch	Face Design	Type	Buttons Qty/dia	Over Size	Weight (Kg)
Super Dominator 400 Halco Shank							
650580	108	4.1/4	Concave	Ballistic	14 x 13mm		9.5
650788	108	4.1/4	Convex	Domed	13 x 13mm		9.5
650987	108	4.1/4	Convex	Semi-Ballistic	15 x 13mm		9.1
653248	108	4.1/4	Concave	Domed / Ballistic	8 x 11mm D/8 x 11mm		9.1
650931	110	4.5/16	Convex	Domed	15 x 13mm		9.6
653106	110	4.5/16	Convex	Semi-Ballistic	18 x 11mm		9
650932	115	4.1/2	Convex	Domed	8 x 14mm / 8 x 13mm		9.7
650936	115	4.1/2	Convex	Ballistic	16 x 13mm		9.7
650969	115	4.1/2	Convex	Semi-Ballistic	16 x 13mm		9.6
653136	115	4.1/2	Convex	Parabolic	17 x 14mm		9.5
653249	115	4.1/2	Concave	Domed/Ballistic	8 x 13mm D/8 x 13mm		9.6
650933	120	4.3/4	Convex	Domed	8 x 14mm / 8 x 13mm		10
650466	127	5	Convex	Domed	16 x 13mm	Y	11
650925	127	5	Convex	Semi-Ballistic	16 x 13mm	Y	10.7
650073	130	5.1/8	Convex	Ballistic	16 x 13mm	Y	10.9
650444	140	5.1/2	Convex	Domed	17 x 13mm	Y	12.5
650445	150	5.7/8	Convex	Domed	17 x 13mm	Y	13.5
IR DHD 340A Shank/Atlas Copco Cop 44							
650950	108	4.1/4	Convex	Domed	15 x 13mm		8
650968	108	4.1/4	Convex	Semi-Ballistic	15 x 13mm		10
650949	110	4.5/16	Convex	Domed	15 x 13mm		8.1
650961	110	4.5/16	Convex	Semi-Ballistic	15 x 13mm		8.1
653091	110	4.5/16	Convex	Parabolic	14 x 14mm		8.5
650526	115	4.1/2	Convex	Domed	16 x 13mm		8.2
650625	115	4.1/2	Concave	Domed/Semi-Ballistic	8 x 14mm D/6 x 13mm S/B		8.2
650955	115	4.1/2	Flat	Domed	8 x 14mm/10 x 13mm		8.3
650967	115	4.1/2	Convex	Semi-Ballistic	16 x 13mm		8.5
650680	120	4.3/4	Concave	Domed/Semi-Ballistic	8 x 13mm/8 x 13mm		10
650612	121	4.3/4	Convex	Semi-Ballistic	14 x 13mm		9.5
650611	127	5	Concave	Domed	16 x 13mm	Y	9.5
650966	127	5	Concave	Semi-Ballistic	16 x 13mm	Y	9.6
650013	127	5	Convex	Domed	16 x 13mm	Y	10.6
650614	130	5.1/8	Concave	Domed/Semi-Ballistic	8 x 14mmD/8 x 13mm S/B	Y	10.1
650675	130	5.1/8	Convex	Semi-Ballistic	16 x 13mm	Y	9.2
653094	140	5.1/2	Concave	Domed	9 x 16mm/9 x 14mm	Y	11.8

4"

SUPER DOMINATOR 450

One piece top-adaptor reduces internal parts. No make up required. External N.R.V. for easy maintenance.

Revised chamber volumes and cycle timing to optimize performance.

Simplified piston geometry for improved balance and location within the cylinder.

Revised cylinder porting to maximise air flow efficiency.

Halco Super Dominator 450 shank reduces contact stresses and wear rates.

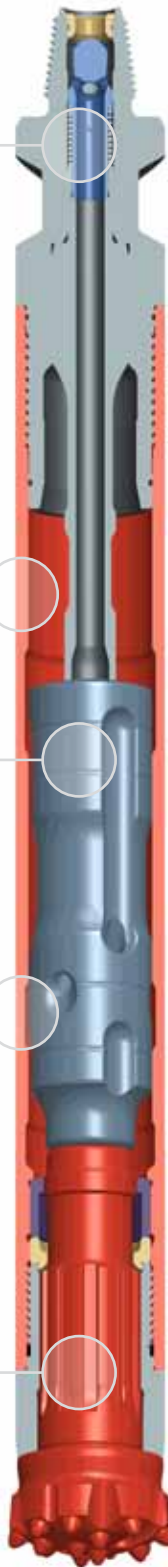

The Super Dominator 450 has been specifically designed for high production drilling in blast-hole applications.

The hammer is robust and has few parts, making it user friendly and reliable. The Super Dominator 450 is fitted with a non-return-valve in top-adaptor for quick and easy inspection and maintenance operations. A fixed air distributor in the top-adaptor body means the Super Dominator 450 requires no shimming which simplifies servicing. The Super Dominator 450 has no liner which increases the piston power output.

The Super Dominator 450 utilizes Halco's all new 12 spline shank which has simplistic robust geometry combined with increased drive contact area. The Super Dominator 450 can be also used with the IR340A/Atlas Copco Cop 44.

Suitable for operation at air pressures of 100 - 350 psi (7 - 24 bar).

Drilling diameters of 110mm - 127mm (4 5/16 - 5").

Air Consumption

SDOM 450 Air Consumption

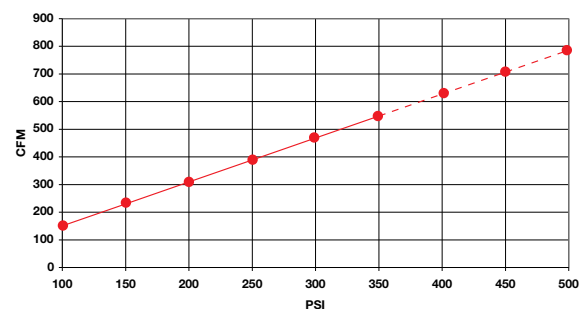

Figures are based on theoretical data

Available Shanks

Halco Super Dominator 450 (NT4)

IR 340A/Atlas Copco Cop 44

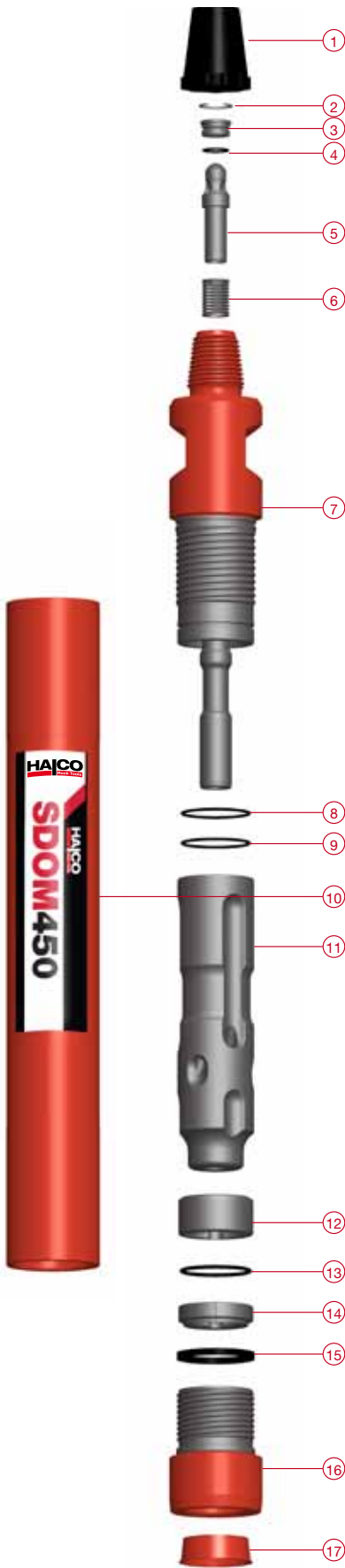

Hammer Overview

Hammer Type	Super Dominator 450	Super Dominator 450
Part Number	600382	600384
Shank	Halco Super Dominator 450	IR DHD 340
Top Thread	2.3/8" API REG PIN	2.3/8" API REG PIN
Hammer Flat Size	65mm (2.560")	65mm (2.560")
Weight	38.5 Kg	38.5 Kg
Outside Diameter	100.5mm (3.956")	100.5mm (3.956")
Make Up Length	914mm (35.984")	914mm (35.984")
Recommended Minimum Thrust	250 Kg (550 lbs)	250 Kg (550 lbs)
Recommended Maximum Thrust	500 Kg (1100 lbs)	500 Kg (1100 lbs)

Parts List

Super Dominator 450		Super Dominator 450	
Shank		Halco	IR 340A/Cop44
Model Number		600382	600384
Item	Description	Part Number	
1	Thread Protector	200111	200111
2	Snap Ring	783049	783049
3	N.R.V. Seat	603919	603919
4	O'Ring	768187	768187
5	Non Return Valve	603918	603918
6	N.R.V. Spring	760142	760142
7	Top-Adaptor	603946	603946
8	O'Ring	768190	768190
9	O'Ring	768190	768190
10	Cylinder	604387	604387
11	Piston	604392	604392
12	Bit Guide Bush	604314	-
13	O'Ring	768189	-
14	Bit Retaining Ring	603948	604414
15	Chuck Lock Ring	602733	602733
16	Chuck	603939	604415
17	End Cap	741019	741046
	Foot Valve	603951	601773
	F/V tool - body	604020	601643
	F/V tool - pusher	601644	601644
	Service Kit	SK59	SK67
	Repair Kit	RK93	RK102

Drill Bits

Part Number	Diameter mm	Inch	Face Design	Type	Buttons Qty/Dia	Over Size	Weight (Kg)
Halco Super Dominator 450							
653217	110	4.5/16	Convex	Ballistic	14 x 14mm		7.96
653223	110	4.5/16	Convex	Domed	14 x 14mm		7.96
653209	115	4.1/2	Convex	Ballistic	15 x 14mm		8.13
653197	127	5	Convex	Ballistic	18 x 14mm	Y	9.05
653268	127	5	Concave	Domed	8 x 13mm + 8 x 14mm	Y	8.75
IR DHD 340A Shank/Atlas Copco Cop 44							
650950	108	4.1/4	Convex	Domed	15 x 13mm		8
650968	108	4.1/4	Convex	Semi-Ballistic	15 x 13mm		10
650949	110	4.5/16	Convex	Domed	15 x 13mm		8.1
650961	110	4.5/16	Convex	Semi-Ballistic	15 x 13mm		8.1
653091	110	4.5/16	Convex	Parabolic	14 x 14mm		8.5
650526	115	4.1/2	Convex	Domed	16 x 13mm		8.2
650625	115	4.1/2	Concave	Domed/Semi-Ballistic	8 x 14mm D/6 x 13mm S/B		8.2
650955	115	4.1/2	Flat	Domed	8 x 14mm/10 x 13mm		8.3
650967	115	4.1/2	Convex	Semi-Ballistic	16 x 13mm		8.5
650680	120	4.3/4	Concave	Domed/Semi-Ballistic	8 x 13mm/8 x 13mm		10
650612	121	4.3/4	Convex	Semi-Ballistic	14 x 13mm		9.5
650611	127	5	Concave	Domed	16 x 13mm	Y	9.5
650966	127	5	Concave	Semi-Ballistic	16 x 13mm	Y	9.6
650013	127	5	Convex	Domed	16 x 13mm	Y	10.6
650614	130	5.1/8	Concave	Domed/Semi-Ballistic	8 x 14mm D/8 x 13mm S/B	Y	10.1
650675	130	5.1/8	Convex	Semi-Ballistic	16 x 13mm	Y	9.2
653094	140	5.1/2	Concave	Domed	9 x 16mm/9 x 14mm	Y	11.8