

8"

DOMINATOR 800

One piece top-adaptor reduces internal parts. No make up required. External N.R.V. for easy maintenance.

Revised chamber volumes and cycle timing to optimize performance.

Simplified piston geometry for improved balance and location within the cylinder,



The Dominator 800 is a general purpose hammer suitable for a wide range of air pressures. The Dominator 800 is a low to mid range air volume hammer. The one piece top-adaptor with N.R.V. (Non-Return-Valve) makes it easy to maintain and service the hammer. The Dominator 800 unique's air distributor finger is integral with the top-adaptor and reduces requirements for shimming. The Dominator 800 has no liner which increases the piston blow energy and reduces parts required. This hammer is suitable for use with overburden systems.

Dominator 800 is available in three different shank types (see below).

Suitable for operation at air pressures of 100 - 435 psi (7 - 30 bar).

Drilling diameters of 200 - 311mm (7 7/8 - 14 1/4").

Air Consumption

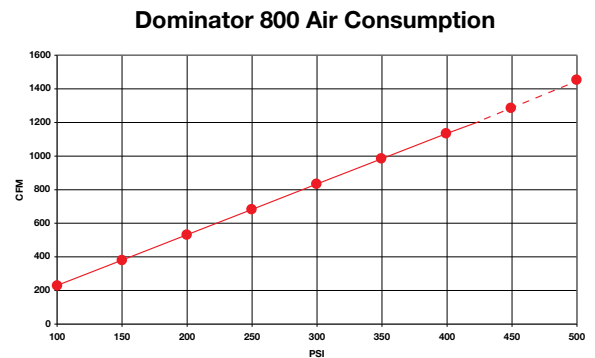

Figures are based on theoretical data

Available Shanks

Halco Mach 80

IR DHD 380

Sandvik Mission A63-15/SD8

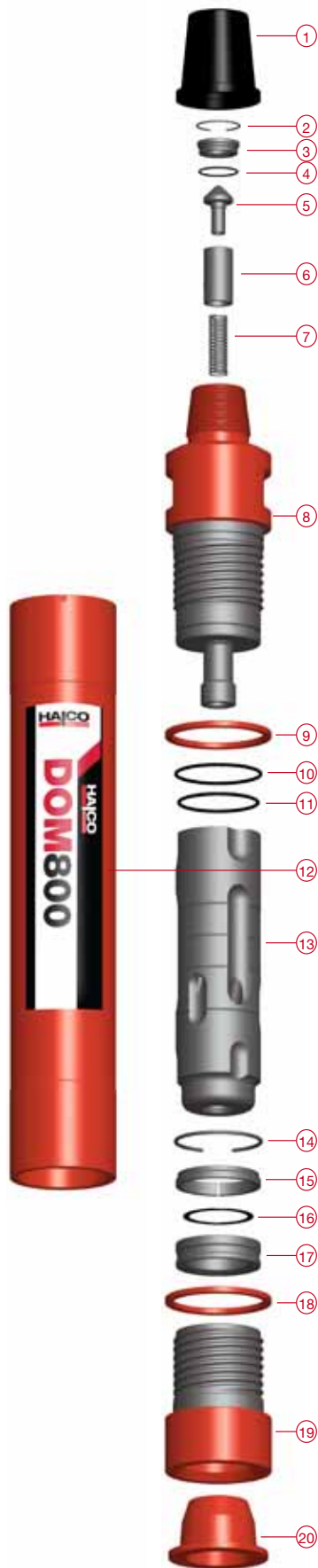

Hammer Overview

	Halco	Sandvik Mission	Ingersoll Rand
Shank	Mach 80	A63-15/SD8	DHD 380
Top Thread	4. 1/2" Api Reg Pin	4. 1/2" Api Reg Pin	4. 1/2" Api Reg Pin
Flat Hammer Size	156mm (6.142")	156mm (6.142")	156mm (6.142")
Weight	175 Kg	180 Kg	181 Kg
Outside Diameter	182mm (7.165")	182mm (7.165")	182mm (7.165")
Make Up Length	1180mm (46.456")	1180mm (46.456")	1180mm (46.456")
Recommended Minimum Thrust	800kg (1760 Lbs)	800kg (1760 Lbs)	800kg (1760 Lbs)
Recommended Maximum Thrust	2000kg (4400 Lbs)	2000kg (4400 Lbs)	2000kg (4400 Lbs)

Parts List

Hammer Type	Dominator 800		
Shank	Halco	A63-15 / SD8	DHD 380
Model Number	600310	600308	600309
Item	Description	Part Number	
1	Thread Protector	207295	207295
2	Snap Ring	783034	783034
3	N.R.V. Seat	602887	602887
4	O'Ring	768150	768150
5	N.R.V.	602285	602285
6	N.R.V. Cover	603696	603696
7	N.R.V. Spring	760108	760108
8	Top-Adaptor	603607	603607
9	Spacer	603576	603576
10	O'Ring	768103	768103
11	O'Ring	768145	768145
12	Cylinder	603687	603687
13	Piston	603754	603755
14	Snap Ring	783015	783015
15	Spacer	-	602840
16	Containment Band	603549	603549
17	Bit Ring	601677	601839
18	Chuck Spacer	603576	603576
19	Chuck	603685	603495
20	End Cap	741034	741027
SK	Service Kit	SK25	SK25
RK	Repair Kit	RK78	RK64
	Foot Valve	601675	601828
	F/V Tool - Body	601820	601820
	F/V Tool - Pusher	601569	601569

Drill Bits

Part Number	Diameter mm	Diameter Inch	Face Design	Type	Buttons Qty	Over Weight Size (Kg)
Halco Mach 80 Shank						
650980	203	8	Convex	Domed	21 x 20mm	51.5
650938	216	8.1/2	Convex	Domed	21 x 20mm	53.0
650571	225	8.7/8	Convex	Domed	26 x 16mm	55.5
650746	254	10	Convex	Domed	21 x 20mm	65.0
653040	300	11.7/8	Flat	Domed	38 x 20mm	Y 83.3
650365	311	12.1/4	Convex	Domed	29 x 20mm	Y 83.0
650908	375	14.3/4	Flat	Domed	40 x 20mm	Y 121.0
Sandvik Mission A63-15/SD8 Shank						
650959	200	7.7/8	Concave	Domed	12x16mm/9x20mm/6x13mm	43.0
650375	203	8	Concave	Domed	10x20mm / 14x16mm	43.5
650693	216	8.1/2	Flat	Domed	10 x 20mm / 24 x 16mm	47.6
650705	222	8.3/4	Concave	Domed	24 x 20mm	46.5
650357	241	9.1/2	Concave	Domed	18 x 20mm	52.5
650606	254	10	Concave	Domed	11x16mm / 18 x 20mm	56.5
650037	254	10	Flat	Domed	28 x 20mm	58.3
653105	270	10.5/8	Concave	Domed	34 x 18mm	57.0
653104	280	11	Concave	Domed	34 x 18mm	Y 59
650039	300	11.7/8	Flat	Domed	29 x 20mm	Y 84.5
Ingersoll Rand Shank - DHD 380						
650977	200	7.7/8	Concave	Domed	31 x 16mm	51.5
650373	203	8	Concave	Domed	10 x 20mm / 14 x 16mm	51.5
650022	241	9.1/2	Concave	Domed	10 x 16 / 18 x 20mm	56.9
650389	254	10	Concave	Domed	18 x 20mm / 10x16mm	64.5
650898	300	11.7/8	Convex	Domed	34 x 20mm	Y 84.5
653041	311	12.1/4	Concave	Domed	42 x 20mm	Y 84.1

8"

DOMINATOR 800 LE

One piece Top Adaptor reduces internal parts. No make up required. External NRV for easy servicing

Drive chamber capacities and air cycle tuned for efficient drilling of soft un-consolidated ground conditions

Optimised piston porting for improved air flow and high frequency operation

Reversible outer cylinder for extended service life

16 spline QL80 shank for maximum strength and durability

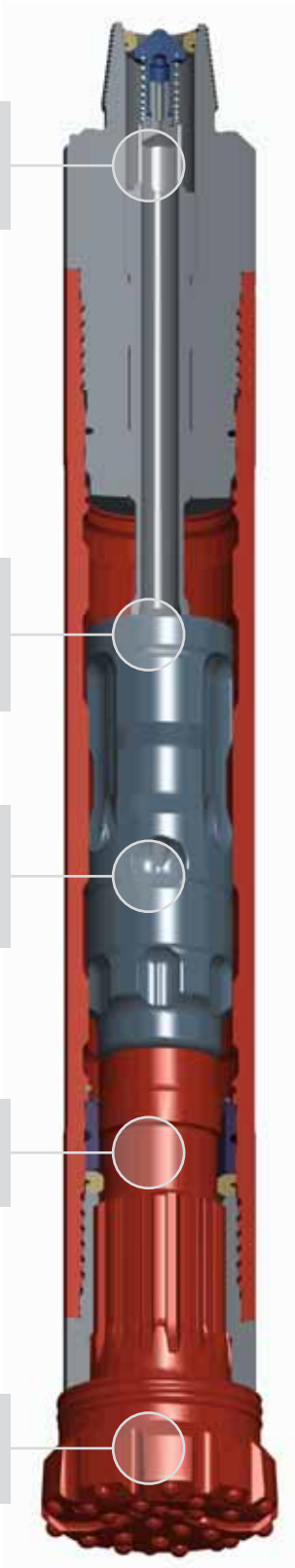

The Dominator 800 LE has been designed for high performance drilling in blast hole application in quarries and mines. Its operating characteristics are particularly suited to soft and un-consolidated ground conditions.

The single piece Top Adaptor/ Air distributor improves reliability and is easy to service. The outer cylinder is hardened for maximum durability and can be reversed to increase service life.

Suitable for operation at air pressures of 100 - 435 psi (7 - 30 bar).

Air Consumption

Dominator 800 LE Air Consumption

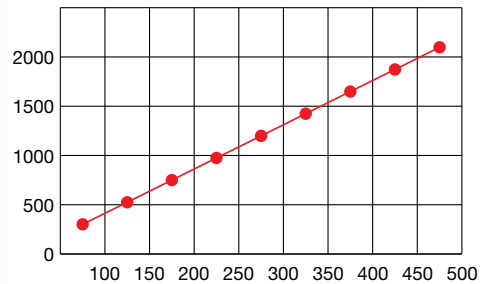

—●— Theoretical Air Consumption

Figures are based on theoretical data

Available Shanks

IR QL 80



Hammer Overview

Hammer Type	Dominator 800 LE
Part Number	600396
Shank	Ingersoll Rand QL 80
Top Thread	4.1/2" Api Reg Pin
Flat Hammer Size	127mm (5")
Weight	178 Kg
Outside Diameter	182mm (7.165")
Make Up Length	1244mm (48.976")
Recommended Minimum Thrust	800 Kg (1760 Lbs)
Recommended Maximum Thrust	2000 Kg (4400 Lbs)

Parts List

Hammer Type		Dominator 800 LE
Shank		IR QL 80
Model Number		600396
Item	Description	Part Number
1	Thread Protector	207295
2	Snap Ring	783034
3	N.R.V. Seat	602887
4	O' Ring	768150
5	Non Return Valve	602285
6	N.R.V. Spring	760117
7	Top Adaptor	604510
8	Spacer	603576
9	O' Ring	768145
10	Piston	604505
11	Cylinder	604506
12	Snap Ring	783033
13	O' Ring	768151
14	Bit Guide Bush	604511
15	Bit Retaining Ring	604347
16	Chuck Spacer	603576
17	Chuck	604507
18	End Cap	741027
SK	Service Kit	SK71
RK	Repair Kit	RK120
	Foot Valve	603334
	F/V Tool - Body	603342
	F/V Tool - Pusher	603341

Drill Bits

Part Number	Diameter		Face Design	Type	Buttons Qty	Over Size	Weight (Kg)
	mm	Inch					
Ingersoll Rand Shank - QL 80							
653062	222	8.3/4	Concave	Domed	14 x 18mm / 10 x 18mm Long		56.8
653239	254	10	Concave	Domed	34x18mm / 12x13mm Retracks		64
653254	270	10.5/8	Concave	Domed	42x18mm / 12x13mm Retracks		69.5
653263	270	10.5/8	Concave	Parabolic	42x18mm / 12x13mm Retracks		69.5

8"

DOMINATOR 850

One piece top-adaptor reduces internal parts. No make up required. External N.R.V. for easy maintenance.

Simplified piston geometry for improved balance and location within the cylinder.

Reversible cylinder.

Revised chamber volumes and cycle timing to optimize performance.

IR QL80 shank reduces contact stresses and wear rates.

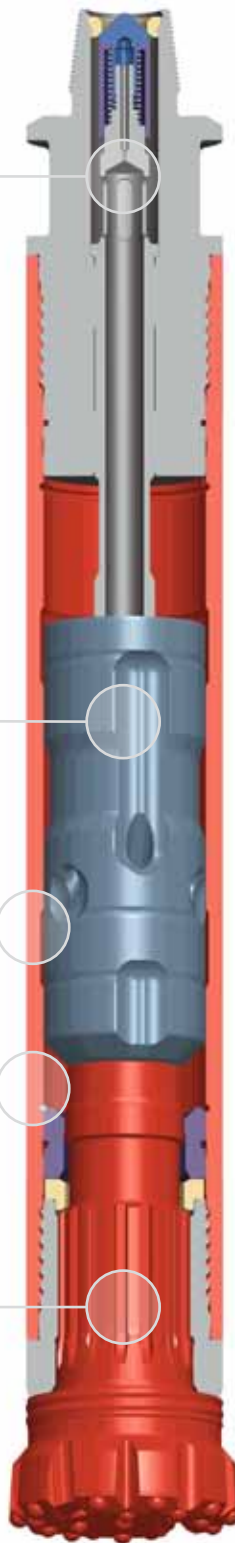

The Dominator 850 has been designed for high performance drilling in hard to medium rock formations, particularly mining applications. Its class leading performance has been achieved with a larger/heavier piston and a valveless air cycle providing a 50% increase in stroke. As well as a reversible cylinder for prolonged hammer life, the Dominator 850 benefits from a QL80 shank design. The one piece top-adaptor with N.R.V. (Non-Return-Valve) makes it easy to maintain and service the hammer. This hammer has few internal parts which makes on site servicing easy with minimum tools needed.

Suitable for operation at air pressures of 100 - 435 psi (7 - 30 bar).

Drilling diameters of 222 - 270mm (8 3/4 - 10 5/8").

Air Consumption

Dominator 850 Air Consumption

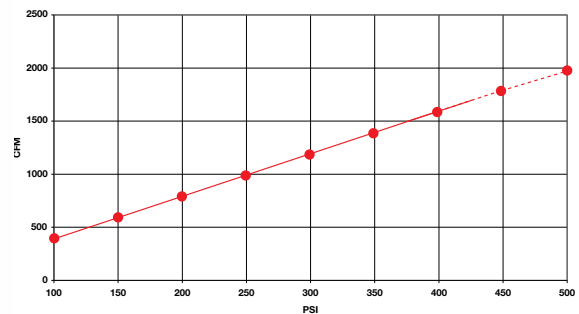

Figures are based on theoretical data

Available Shanks

IR QL 80



Hammer Overview

Hammer Type	Dominator 850
Part Number	600245
Shank	Ingersoll Rand QL 80
Top Thread	4. 1/2" Api Reg Pin
Flat Hammer Size	125mm (4.921")
Weight	210 Kg
Outside Diameter	192mm (7.559")
Make Up Length	1281mm (50.433")
Recommended Minimum Thrust	800kg (1760 Lbs)
Recommended Maximum Thrust	2000kg (4400 Lbs)

Parts List

Hammer Type	Dominator 850	
Shank	QL80	
Model Number	600245	
Item	Description	Part Number
1	Thread Protector	207295
2	Snap Ring	783034
3	N.R.V. Seat	602887
4	O'Ring	768150
5	N.R.V.	602285
6	N.R.V. Cover	603696
7	N.R.V. Spring	760108
8	Top-Adaptor	603353
9	Spacer	603358
10	O'Ring	768169
11	Piston	603349
12	Cylinder	603347
13	Snap Ring	783039
14	O'Ring	768169
15	Bit Guide Bush	603360
16	Bit Ring	603359
17	Chuck Spacer	603358
18	Chuck	603357
19	End Cap	741027
SK	Service Kit	SK32
RK	Repair Kit	RK55
	Foot Valve	603334
	Body	603342
	Pusher	603341

Drill Bits

Part Number	Diameter		Face Design	Type	Buttons Qty	Over Weight Size (Kg)
	mm	Inch				
Ingersoll Rand Shank - QL 80						
653062	222	8.3/4	Concave	Domed	14 x 18mm / 10 x 18mm Long	56.8
653239	254	10	Concave	Domed	34x18mm / 12x13mm Retracks	64
653254	270	10.5/8	Concave	Domed	42x18mm / 12x13mm Retracks	69.5
653263	270	10.5/8	Concave	Parabolic	42x18mm / 12x13mm Retracks	69.5

8"

DOMINATOR 880

One piece top-adaptor reduces internal parts. No make up required. External N.R.V. for easy maintenance.

Reversible cylinder.

Simplified piston geometry for improved balance and location within the cylinder.

Revised chamber volumes and cycle timing to optimize performance.

IR QL80 shank reduces contact stresses and wear rates.

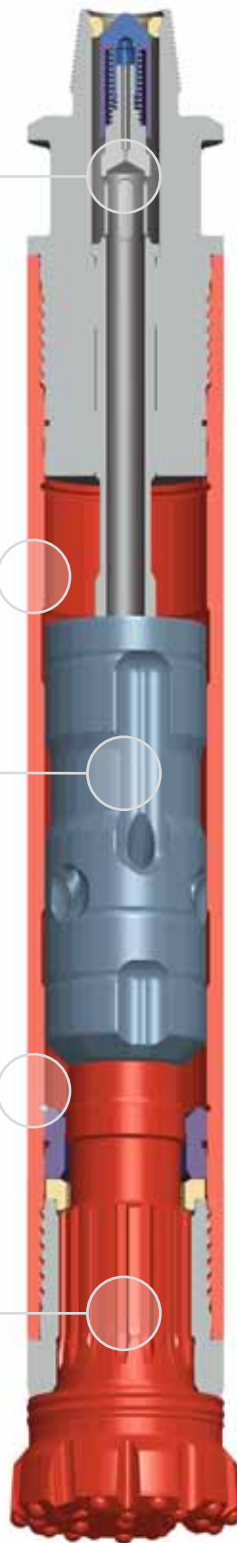

The Dominator 880 is a general purpose hammer suitable for a wide range of air pressures.

The Dominator 880 is a well drilling hammer with a mid to high range air volume. The one piece top-adaptor with N.R.V. (Non-Return-Valve) makes it easy to maintain and service the hammer. A choice of blank, 4mm, 6mm or 8mm chokes can be fitted to provide varied air flow making the Dominator 880 a versatile hammer. The wide body diameter of the Dominator 880 allows for an increased piston weight and, therefore, an improved performance. The unique air distributor integral with top-adaptor reduces requirements for shimming.

Suitable for operation at air pressures of 100 - 435 psi (7 - 30 bar).

Drilling diameters of 200 - 311 mm (7 7/8 - 12 1/4").

Air Consumption

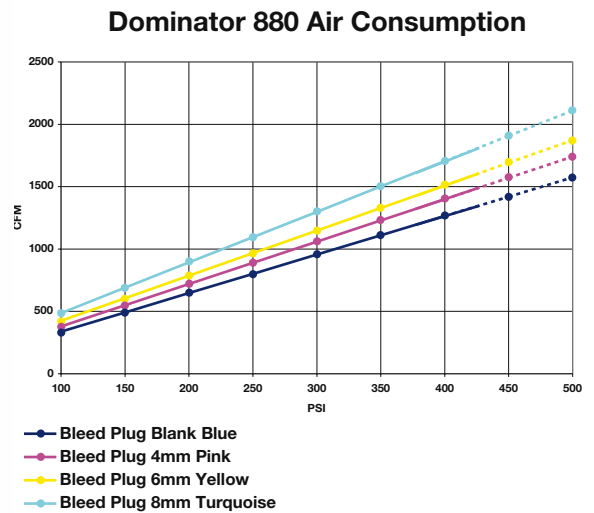

Figures are based on theoretical data

Available Shanks

IR QL 80

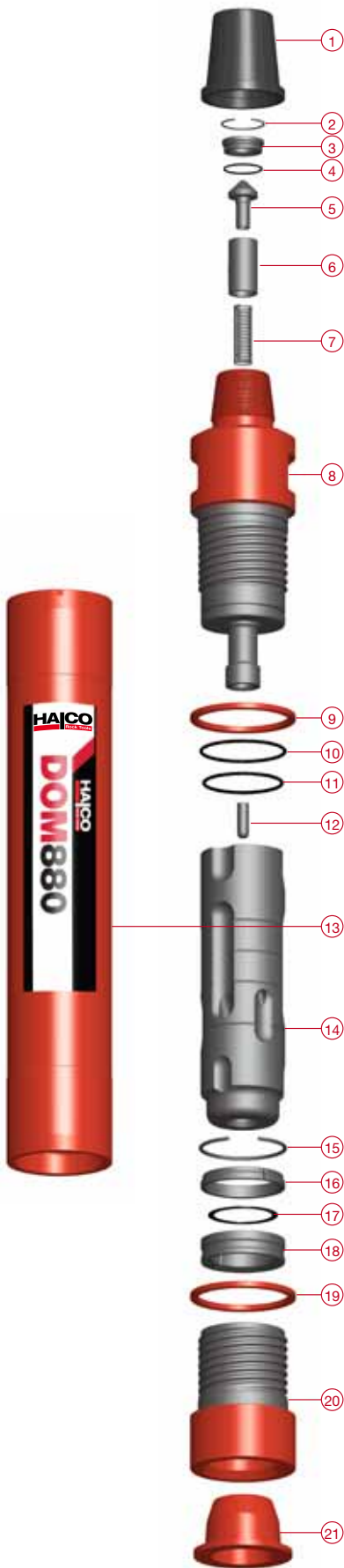

Hammer Overview

Hammer Type	Dominator 880	
Part Number	600311	600312
Shank	Sandvik Mission	Ingersoll Rand
	A63-15/SD8	DHD 380
Top Thread	4. 1/2" Api Reg Pin	4. 1/2" Api Reg Pin
Flat Hammer Size	156mm (6.142")	156mm (6.142")
Weight	177 Kg	177 Kg
Outside Diameter	182mm (7.165")	182mm (7.165")
Make Up Length	1263mm (49.724")	1263mm (49.724")
Recommended Minimum Thrust	800kg (1760 Lbs)	800kg (1760 Lbs)
Recommended Maximum Thrust	2000kg (4400 Lbs)	2000kg (4400 Lbs)

Parts List

Hammer Type	Dominator 880	
Shank	A63-15 / SD8	DHD 380
Model Number	600311	600312
Item	Description	Part Number
1	Thread Protector	207295
2	Snap Ring	783034
3	N.R.V. Seat	602887
4	O'Ring	768150
5	Non Return Valve	602285
6	N.R.V. Cover	603696
7	N.R.V. Spring	760108
8	Top-Adaptor	603607
9	Spacer	603576
10	O'Ring	768103
11	O'Ring	768145
12*	Blank Plug (Blank)	602450
	Blank Plug (4mm)	602451
	Blank Plug (6mm)	602452
	Blank Plug (8mm)	602453
13	Cylinder	603691
14	Piston	603614
15	Snap Ring	783015
16	Spacer	-
17	Containment Band	768102
18	Bit Ring	601839
19	Chuck Spacer	603576
20	Chuck	603686
21	End Cap	741027
SK	Service Kit	SK51
RK	Repair Kit	RK79
	Foot Valve	601828
	F/V Tool - Body	601829
	F/V Tool - Pusher	601569

Drill Bits

Part Number	Diameter mm	Inch	Face Design	Type	Buttons Qty	Over Weight Size (Kg)
Sandvik Mission A63-15/SD8 Shank						
650959	200	7.7/8	Concave	Domed	12x16mm/9x20mm/6x13mm	43.0
650375	203	8	Concave	Domed	10x20mm / 14x16mm	43.5
650922	203	8	Concave	Domed/S-Ballistic	10x20mmd/14x16mmsb	43.0
650837	219	8.5/8	Concave	Domed	18 x 20mm	46.0
650705	222	8.3/4	Concave	Domed	24 x 20mm	46.5
650357	241	9.1/2	Concave	Domed	18 x 20mm	52.5
650606	254	10	Concave	Domed	11x16mm / 18 x 20mm	56.5
650037	254	10	Flat	Domed	28 x 20mm	58.3
653105	270	10.5/8	Concave	Domed	34 x 18mm	57.0
650039	300	11.7/8	Flat	Domed	29 x 20mm	Y 84.5
Ingersoll Rand Shank - DHD 380						
650977	200	7.7/8	Concave	Domed	31 x 16mm	52.0
650373	203	8	Concave	Domed	10 x 20mm / 14 x 16mm	51.5
650022	241	9.1/2	Concave	Domed	10 x 16 / 18 x 20mm	56.9
650389	254	10	Concave	Domed	18 x 20mm / 10x16mm	64.5
650898	300	11.7/8	Convex	Domed	34 x 20mm	Y 84.5
653041	311	12.1/4	Concave	Domed	42 x 20mm	Y 84.1

8"

DOMINATOR 880 DW

One piece top-adaptor reduces internal parts. No make up required. External N.R.V. for easy maintenance.

Simplified piston geometry for improved balance and location within the cylinder.

Revised chamber volumes and cycle timing to optimize performance.

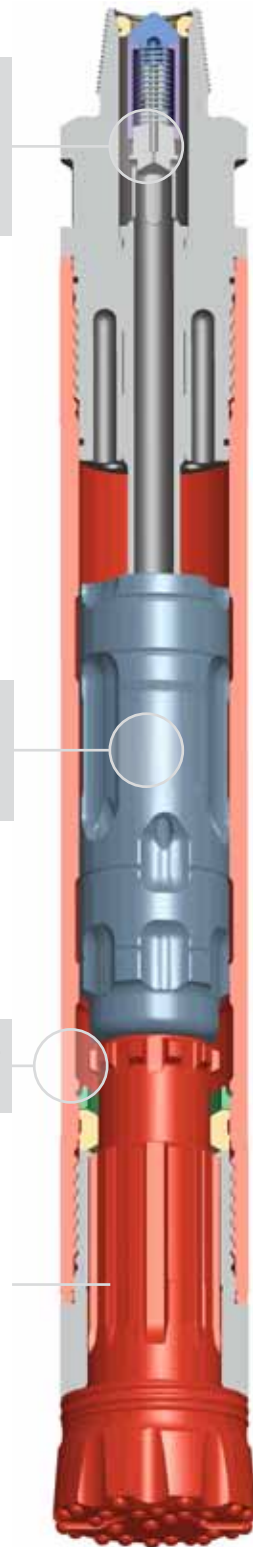

The Dominator 880 Deep-Well hammer has been specifically designed for drilling deep holes under a head of water. The one piece top-adaptor with N.R.V. (Non-Return-Valve) makes it easy to maintain and service the hammer. The wide body diameter of the Dominator 880 DW allows for an increased piston weight and therefore an improved performance. A variable choke for increased air volume can be fitted to the Dominator 880 DW to suit compressor volume outputs.

Suitable for operation at air pressures of 100 - 435 psi (7 - 30 bar).

Drilling diameters of 200 - 311 mm (7 7/8 - 12 1/4").

Air Consumption

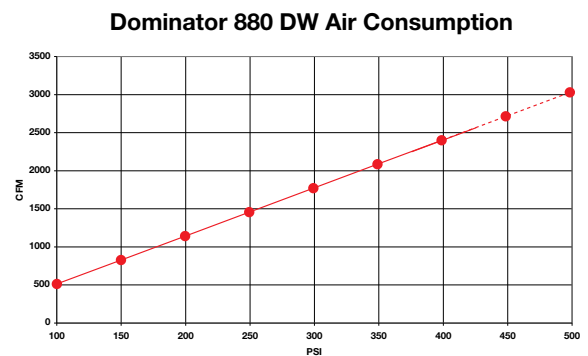

Figures are based on theoretical data

Available Shanks

IR DHD 380

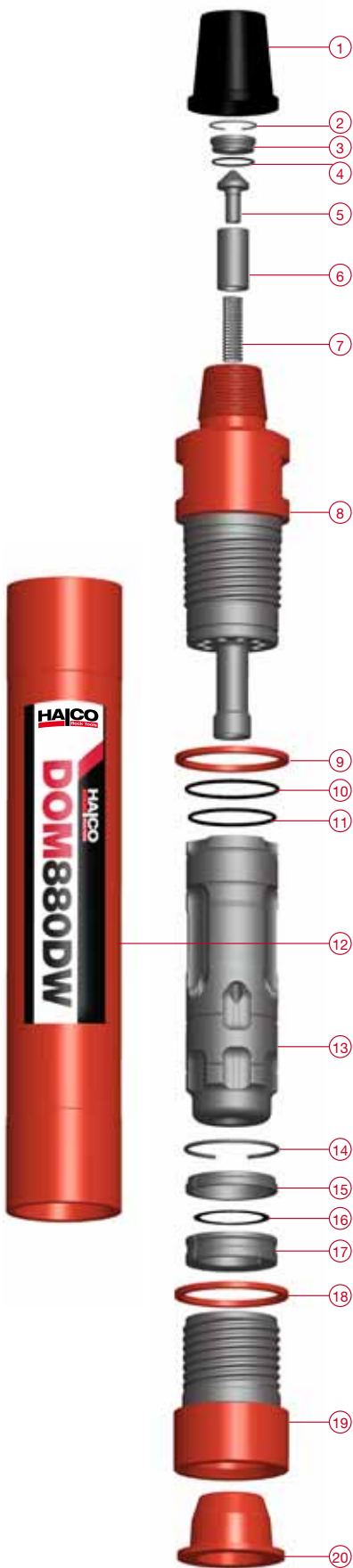

Hammer Overview

Hammer Type	Dominator 880DW
Part Number	600261
Shank	Ingersoll Rand
	DHD 380
Top Thread	4. 1/2" Api Reg Pin
Flat Hammer Size	156mm (6.142")
Weight	177 Kg
Outside Diameter	182mm (7.165")
Make Up Length	1263mm (49.724")
Recommended Minimum Thrust	800kg (1760 Lbs)
Recommended Maximum Thrust	2000kg (4400 Lbs)

Parts List

Hammer Type	Dominator 880DW	
Shank	DHD 380	
Model Number	600261	
Item	Description	Part Number
1	Thread Protector	207295
2	Snap Ring	783034
3	N.R.V. Seat	602887
4	O'Ring	768150
5	Non Return Valve	602285
6	N.R.V. Cover	603696
7	N.R.V. Spring	760108
8	Top-Adaptor	603498
9	Spacer	603576
10	O'Ring	768103
11	O'Ring	768145
12	Cylinder	603496
13	Piston	602743
14	Snap Ring	783015
15	Spacer	602840
16	Containment Band	603549
17	Bit Ring	603043
18	Chuck Spacer	603576
19	Chuck	603495
20	End Cap	741027
SK	Service Kit	SK25
RK	Repair Kit	RK64
	Foot Valve	603334
	F/V Tool - Body	603342
	F/V Tool - Pusher	6013341

Drill Bits

Part Number	Diameter		Face Design	Type	Buttons Qty	Over Size	Weight (Kg)
	mm	Inch					
Ingersoll Rand Shank - DHD 380							
650977	200	7.7/8	Concave	Domed	31 x 16mm		52.0
650373	203	8	Concave	Domed	10 x 20mm / 14 x 16mm		51.5
650022	241	9.1/2	Concave	Domed	10 x 16 / 18 x 20mm		56.9
650389	254	10	Concave	Domed	18 x 20mm / 10x16mm		64.5
650898	300	11.7/8	Convex	Domed	34 x 20mm	Y	84.5
653041	311	12.1/4	Concave	Domed	42 x 20mm	Y	84.1